



USE & CARE OF YOUR FLAT WASH BRUSHES



PROFESSIONALARTISTSBRUSHES.COM
PKB SELECT

Thank you for purchasing this set of three professional flat wash brushes.

In this document I will share tips on how to get the most out of your brushes in daily use and how to take care for them to protect your investment and ensure a long, productive life of your brushes.

I want to make sure you get off to a good start as you open your package and take out your new brushes.

IMPORTANT!

**Read This Before You Use Your Brushes
For The First Time!**

Did you know that static electricity on the paint brush assembly line can cause stray hairs or dust to adhere to brushes or packaging on even the most expensive, luxury brand brushes?

Therefore always prepare your new brushes by washing them gently in running water while stroking gently with your fingers along the length of the bristles.

This will remove any stray hairs or dust picked up in assembly or packaging.

Now you are ready to put your new brushes to your favorite mediums and get started on your artwork.

Need to Replace Your Flat Wash Brushes?

Get them here:

<http://www.amazon.com/gp/product/B00C30E6HE>

See the video on Use and Care of Your Flat Wash Brushes.

<https://www.youtube.com/watch?v=eZQ1JDmw6CU>

--0--

Professional Artists Brushes Are An Investment

Professional artist's brushes are an investment and you lose money and time if they don't perform as promised, are hard to take care of, fall apart after a few uses and cost more than other brushes. As a professional artist I know this.

So How do I Buy a Brush?

This is what I look for.



The brush must be able to do the job I want it to do quickly, efficiently and without a lot of fuss and preparation. In other words, the best brush for the job and it must be easy to clean and maintain. For acrylic media, that usually means I am looking for a quality synthetic brush.

It can be used many times for its original purpose. It is recyclable or can be repurposed for other uses after it is worn out. And it must be the least expensive brush that delivers on all these important points.

How Do The Flat Wash Brushes By Professional Artist Brushes Measure Up?

I looked for brushes that met all of the criteria above before offering them for sale on Amazon. I have been painting since I was 12 years old and I discovered these brushes at an art supply store and I use them all the time, but lately the price has gone through the roof.

I searched and found a supplier and I am now able to offer them to you at the same low price that I used to enjoy. I buy them in bulk and you can get them from me on Amazon.

--0--

How to Use Your Flat Wash Brushes

These wash brushes do a beautiful job of providing even coverage with no brush strokes in acrylic, watercolor, oil and many other soft artist's mediums.

First mix the paint with water, acrylic or oil into a consistent fluid. Practice on extra paper or canvas to ensure you have the right amount of fluid and paint.

With these strong, soft synthetic bristles and fluid paint the brush strokes will quickly disappear to provide excellent flat coverage.



I like to use watercolor techniques to lay in backgrounds in acrylic.

I make a very fluid watery paint and apply thinly. Just before it dries, I sprinkle the surface with drops of alcohol that move the paint leaving intricate designs.

Perfect for Large Paintings and Murals...

Flat wash brushes are perfect for large paintings and murals, anything you do that involves having to cover large flat surfaces evenly, efficiently and without leaving brush strokes.

In the painting below they have been used to apply thin layers of transparent paint layered over other layers to create designs and depth.



Perfect for a Finished Glossy Appearance

In my painting below, they have been used to apply transparent acrylic pouring medium to provide a finished glossy appearance in one easy step.



--0--

What These Brushes Will Do For You

These brushes will do three things for you:

1. Speed up the workflow
2. Allow you to work quickly and creatively in different mediums
3. Become workhorses of your painting practice



--0--

How to Care for Your New Flat Wash Brushes

Professional Artist Brushes from PKB Select are easy to clean. Just follow these simple steps.

Before You Paint...

Always, always wet the brushes with water (or oils if you are painting in oils) before dipping them in paint.

After You Paint...

After you have finished painting and while the paint is still wet, **remove excess paint from the bristles** with a rag (I use unscented baby wipes) or by painting out the paint on a disposable surface like the pages from an old phone book.



Using a brush soap or woods oil soap, I **wet the brush and gently wipe it across or through the soap** and then work it through the bristles on a flat surface or on the palm of my hand.

Once the soap is thoroughly mixed through the bristles, I **rinse the brush gently** with warm water.



I **repeat adding soap and rinsing** until there is no evidence of the paint on the brush or in the running water.

Final Touch...

Once the brush is clean, I add a little more soap and gently shape the bristles to lay flat.

Dry Your Brushes the Right Way...

Don't dry the brush with the bristles down!

They will be distorted.

Don't dry brushes with the bristles up!

This will send moisture into the metal ferrule and the wooden handle.

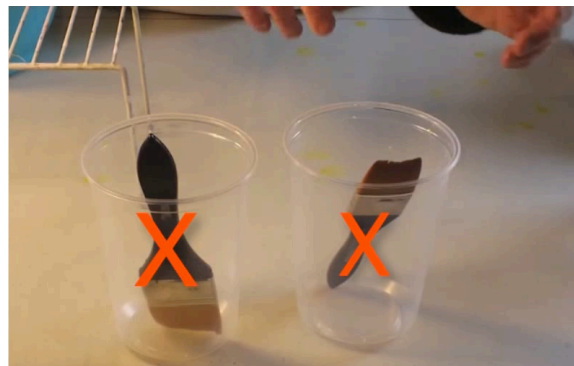

Always lay the brush on its side to dry. Once dry, they can be put in a brush rack with the bristles up.



Important Tip...

*Never, ever let acrylic paint dry on the brush.
You may be able to remove it, but the brush will never be the same.*

If you can't wash the brush right away, you can leave it soaking in water, but make sure the ferrule is above the water or it may rust if there are any scratches in the metal coating.

It is true that watercolor and oil can be removed after the paint has been left on the brush, but the brush will last much longer if it is cleaned after each painting session.

Always wash your brush as soon as you have finished your painting session!

These Brushes Last A Long Time...

In the picture below you can see old brushes I have had for more than six years.



They are still good brushes and I use them all the time though I will use a newer one if I want to paint sharp edges.

When properly cared for, your set of wash brushes will give you years of dependable service.

Don't Throw Out Worn Out Brushes...

And when your wash brushes have worn out, don't throw them away. Use them for other techniques!

Here is one where the bristles have been cut and shaped to give different effects that I can't get with a new brush. Experiment with your worn out brushes.



Now Go Paint!

Try these brushes on your own.

Once you have used them, they will become part of your painting kit.

And remember: use bigger brushes, paint faster, paint bigger and have more fun!

Need to Replace Your Flat Wash Brushes?

Get them here:

<http://www.amazon.com/gp/product/B00C30E6HE>

--0--